

REVISIONS				
ZONE	REV	DESCRIPTION	DATE	APPROVED
A	RELEASED		06/02/2000	B. RUSSETT

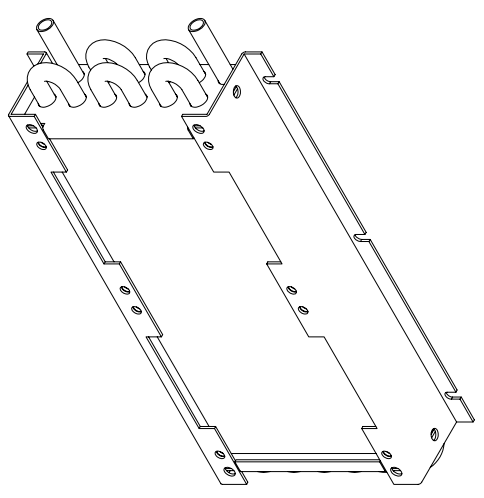
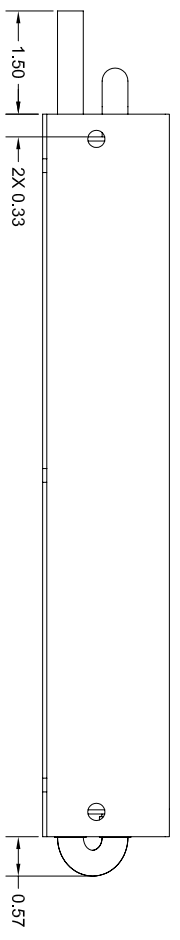
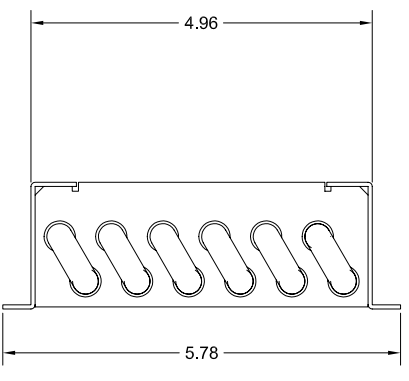
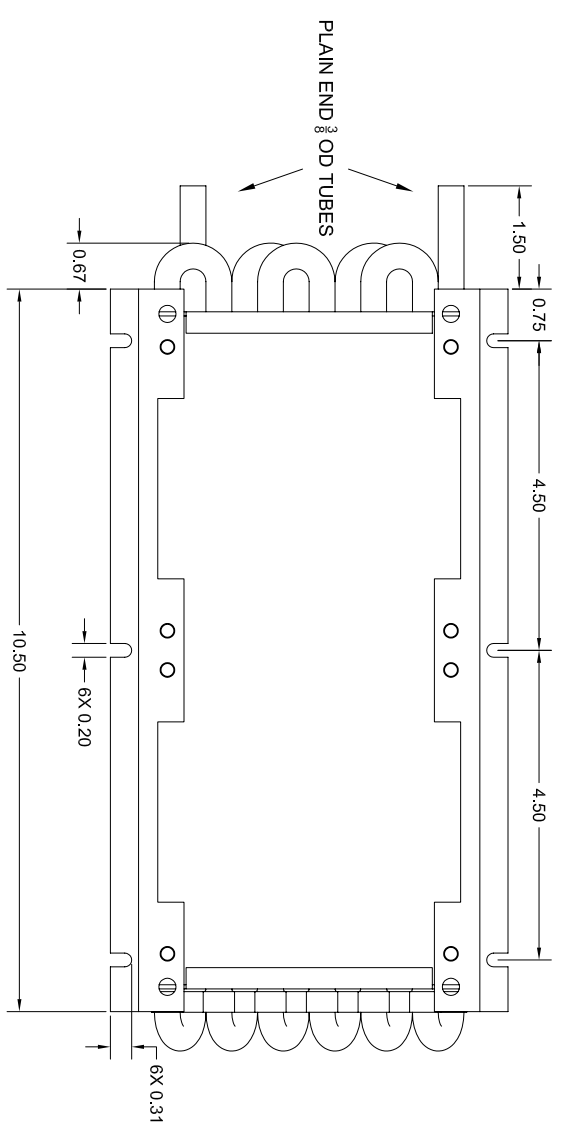
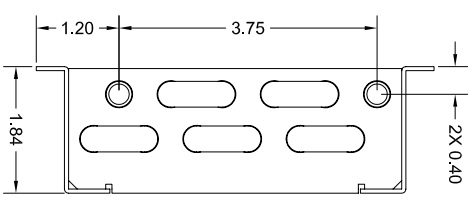

NOTES:

1. ALL PARTS MUST BE CLEANED PRIOR TO BRAZING.
2. BRAZING TO BE DONE USING SIL-FOS OR EQUIVALENT
3. CAP FITTINGS, CAPS AFTER COMPLETE.
4. PRESSURE TEST ASSEMBLY TO 150 PSI.
5. STABILIZE INTERIOR SURFACES WITH COBRATEC SOLUTION, FLUSH CLEAN, AND DRY.
6. PAINT ENTIRE ASSY. WITH SHERWIN WILLIAMS POLANE, (GRAY). PAINT MUST BE SCRATCH RESISTANT AND MUST PASS STANDARD PEEL TEST.
7. APPLY LABEL AND MARK WITH MODEL NUMBER AND SERIAL NUMBER.

CONFIDENTIAL INFORMATION		THEMATRON ENGINEERING INC.	
MANUFACTURED BY: THEMATRON ENGINEERING INC. DATE: 06/02/2000 DRAWN BY: B. RUSSETT CHECKED BY: B. RUSSETT APPROVED BY: B. RUSSETT	PART NUMBER: 10006 REV: 0 DATE: 06/02/2000 DRAWN BY: B. RUSSETT CHECKED BY: B. RUSSETT APPROVED BY: B. RUSSETT	TITLE: HEAT EXCHANGER SCALE: 1:1 SHEET: 1 OF 1	COMPANY: THEMATRON ENGINEERING INC. ADDRESS: 10006 CITY: BOSTON STATE: MA ZIP: 02116